

AIRPORT DIAGRAM

AL-5349 (FAA)

MIAMI EXEC (TMB)
MIAMI, FLORIDA

SE-3, 31 OCT 2024 to 28 NOV 2024

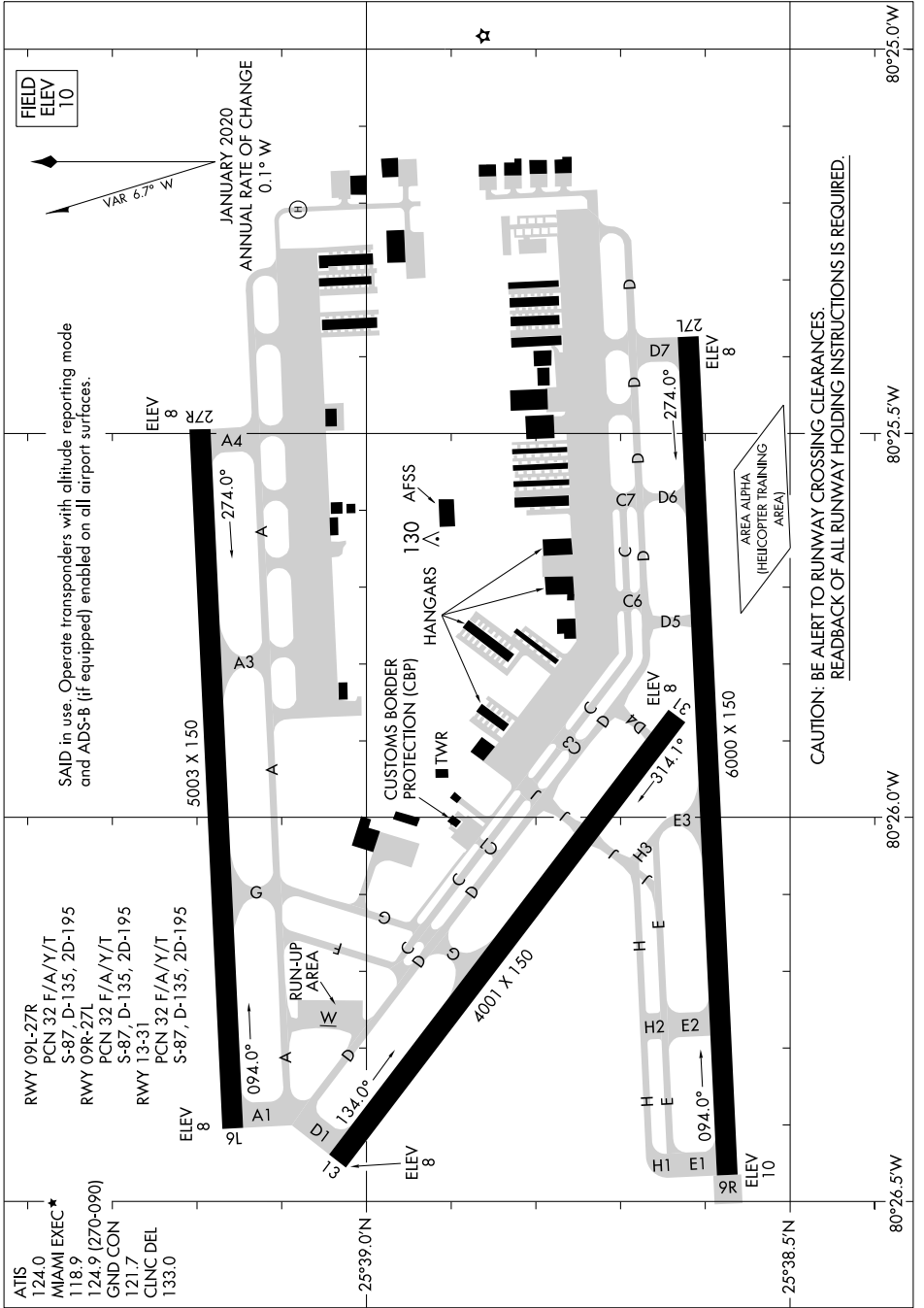

FIELD
ELEV
10

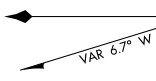

JANUARY 2020
ANNUAL RATE OF CHANGE
0.1° W

SAID in use. Operate transponders with altitude reporting mode and ADS-B (if equipped) enabled on all airport surfaces.

CAUTION: BE ALERT TO RUNWAY CROSSING CLEARANCES.
READBACK OF ALL RUNWAY HOLDING INSTRUCTIONS IS REQUIRED.

AIRPORT DIAGRAM

MIAMI, FLORIDA
MIAMI EXEC (TMB)

SE-3, 31 OCT 2024 to 28 NOV 2024